

# AC924 Series

**Class I, Division 2 / Zone 2 Accelerometer, For Use In “Non-Arcing, Non-Sparking” Environments, Side Exit Connector, 50 mV/g**

**Must Use “Class I, Division 2”  
CB190 Cable and D2Q Connectors**  
**Product Features**

**Class I, Division 2 / Zone 2 Rating**

**Excellent for Higher g Applications**



Actual Product Size Shown

- $\pm 100$  g, Dynamic Range
- 50 mV/g,  $\pm 10\%$  Sensitivity
- 1,0-10000 Hz (60-600,000 CPM)

## AC924-1A

2 Pin Connector

Connector Pin	Polarity
A	(+) Signal / Power
B	(-) Common

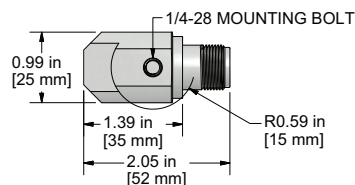
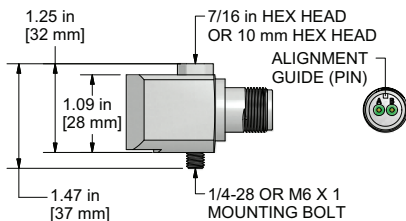

Specifications	Standard	Metric
Part Number	AC924	M/AC924
Sensitivity ( $\pm 10\%$ )	50 mV/g	
Frequency Response ( $\pm 3$ dB)	60-600,000 CPM	1,0-10000 Hz
Frequency Response ( $\pm 10\%$ )	90-300,000 CPM	1,5-5000 Hz
Dynamic Range	$\pm 100$ g, peak	
<b>Electrical</b>		
Settling Time	<3 Seconds	
Voltage Source	18-28 VDC	
Constant Current Excitation	2-4 mA	
Spectral Noise @ 10 Hz	9 $\mu$ g/ $\sqrt$ Hz	
Spectral Noise @ 100 Hz	2 $\mu$ g/ $\sqrt$ Hz	
Spectral Noise @ 1000 Hz	1.6 $\mu$ g/ $\sqrt$ Hz	
Output Impedance	<100 ohm	
Bias Output Voltage	10-14 VDC	
Case Isolation	>10 <sup>8</sup> ohm	

Specifications	Standard	Metric
<b>Environmental</b>		
Temperature Range	-58 to 250°F	-50 to 121°C
Maximum Shock Protection	5,000 g, peak	
Electromagnetic Sensitivity	CE	
Sealing	Welded, Hermetic	
<b>Physical</b>		
Sensing Element	PZT Ceramic	
Sensing Structure	Shear Mode	
Weight	5.3 oz	150 grams
Case Material	316L Stainless Steel	
Mounting	1/4-28	
Connector (non-integral)	2 Pin MIL-C-5015	
Resonant Frequency	1,320,000 CPM	22000 Hz
Mounting Torque	2 to 5 ft. lbs.	2,7 to 6,8 Nm
Mounting Hardware	1/4-28 Captive Bolt	M6x1 Captive Bolt
Calibration Certificate	CA10	

## Ordering Information

Standard	AC924-1A (1/4-28 Captive Bolt)
Metric	M/AC924-1A (M6x1 Captive Bolt)

**Read Before Purchasing**  
Important information on  
**Regulatory Approvals and Requirements**  
on Page 42



**Backed by our Unconditional Lifetime Warranty**